

**ORDERING INFORMATION:**  
 #WPA60-{STROKE}-{COUPLER}-{DIRECTION OF STOP}  
 25-100mm  
 RAP or RIGID  
 EXT

**OPTIONS NOTES:**  
 1) COUPLER OPTION: RAP COUPLING CAUSES THE UNIT STROKE TO BE 3mm [.12"] LESS THAN THE NOMINAL STROKE OF THE CYLINDER. UNLESS OTHERWISE SPECIFIED, THE PNEUMATIC CYLINDER COMES STANDARD WITH THE RAP COUPLING.  
 2) DIRECTION OF STOP OPTION: SPECIFY THE DIRECTION FOR THE ADJUSTABLE STOP. UNIT CAN STOP IN THE EXTEND, "-EXT", OR THE RETRACT, "-RET", DIRECTION OF STROKE. FOR DIMENSIONAL INFORMATION ON "-RET" OPTION, SEE RETRACT STOP TEMPLATE.  
 3) UNITS COME STANDARD WITH A SHROUD AS SHOWN. TO ORDER THE UNIT WITHOUT A SHROUD, ADD SUFFIX "-NS" TO THE END OF THE PART NUMBER.

**PART NUMBER EXAMPLES:**  
 TO ORDER UNIT AS SHOWN WITH 25mm STROKE, RIGID COUPLING, & EXTEND STOP, ORDER AS:  
 #WPA60-25-RIGID-EXT  
 TO ORDER UNIT AS SHOWN WITH A RAP COUPLING, EXTEND STOP & NO SHROUD, ORDER AS:  
 #WPA60-23-NS-EXT

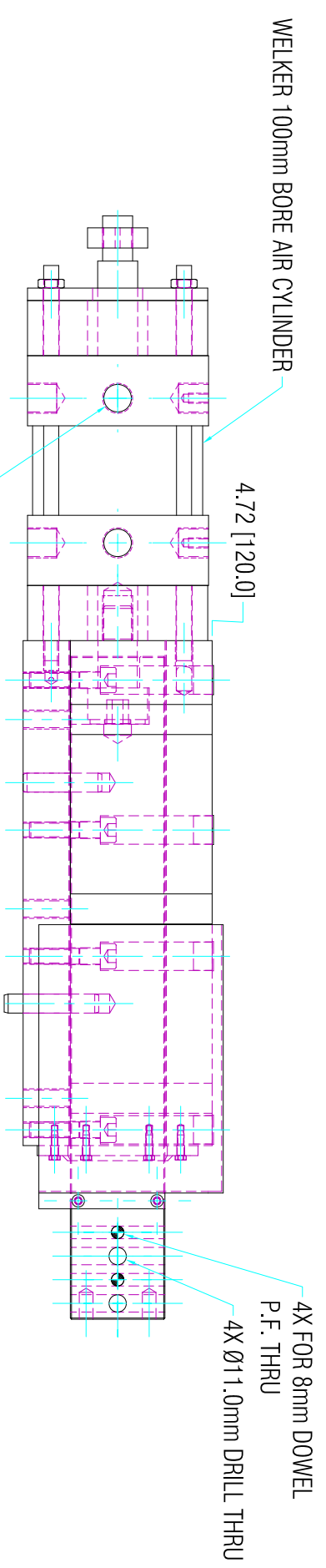

## EXTEND STOP TEMPLATE ONLY

**NOTES:**  
 1. 1.250" READ DEPTH PROX PORTS AT POSITION 1.  
 THE CYLINDER CAN BE FIELD ROTATED TO PLACE THE PROX MOUNT AT ANY LOCATION.

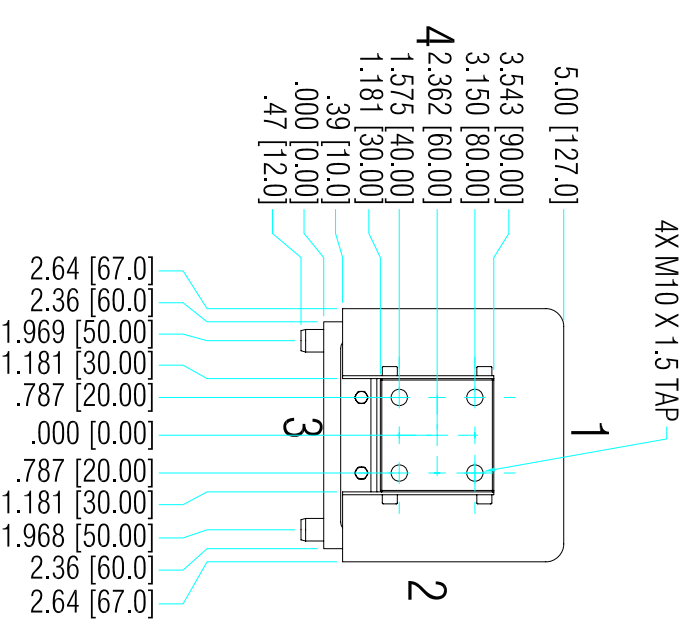

UNIT WGT 71 LBS

		DATE	1/4/2005	STATUS	Released
		DATE	1/4/2005	STATUS	Released
<b>TEMPLATE</b>		DATE	1/4/2005	STATUS	Released
WPA60 SERIES SHOTPIN W/ SHORT STROKE OPTION		DATE	1/4/2005	STATUS	Released
WPA60L21.DWG		DATE	1/4/2005	STATUS	Released