

ORDER NUMBER:
 #SBS40-{STROKE}-{HYD. CYL OPTION}-{COUPLER}-{HARD STOP OPTION}-{CYLINDER POSITION}-{SHIM}
 75-100mm _____ (SEE SHIM NOTE)
 H _____ C1, C2, C3
 RAP OR RIDGID _____ HS

OPTIONS NOTES:
 1) **CYL OPTION:** SBS40 COMES STANDARD WITH WELKER 63mm BORE AIR CYLINDER, UNLESS HYDRAULIC OPTION, "-H", IS SPECIFIED. HYDRAULIC CYLINDERS HAVE 40mm BORE. DO NOT OPERATE ABOVE 200 PSI.
 2) **COUPLER OPTION:** RAP COUPLING CAUSES THE UNIT STROKE TO BE 2mm[.08"] LESS THAN THE NOMINAL STROKE OF THE CYLINDER. UNLESS OTHERWISE SPECIFIED, THE PNEUMATIC CYLINDER COMES STANDARD WITH THE RAP COUPLING AND THE HYDRAULIC CYLINDER COMES STANDARD WITH THE RIGID COUPLING.
 3) **HARD STOP OPTION:** SBS40 DOES NOT COME STANDARD WITH THE HARD STOPS. HARD STOP OPTION IS NOT AVAILABLE WITH THE HYDRAULIC CYLINDER OPTION.
 4) **CYLINDER POSITION OPTION:** BOTH PNEUMATIC & HYDRAULIC UNITS COME STANDARD WITH CYLINDER IN POSITION SHOWN.
 5) **SHIM OPTION:** SHIM SIZES CAN BE ORDERED IN .25mm INCREMENTS FROM .25mm-5mm, HARD STOP OPTION MUST BE USED IF ORDERING SHIMS. DUE TO SWITCH LIMITATIONS, SHIMMING PAST 5mm IS NOT RECOMMENDED. LEAVE BLANK IF NO SHIMS REQUIRED.
 6) UNIT COMES WITH SHROUD AS STANDARD. TO ORDER WITHOUT SHROUD ADD "-NS" SUFFIX TO PART NUMBER.

PART NUMBER EXAMPLES:
 TO ORDER UNIT AS SHOWN WITH 100mm STROKE, RIGID COUPLING, & HARD STOP OPTION, ORDER AS:
 #SBS40-100-RIGID-HS-C1
 TO ORDER UNIT AS SHOWN WITH A RAP COUPLING & NO SHROUD:
 #SBS40-98-HS-C1-NS
 TO ORDER UNIT AS SHOWN WITH HYDRAULIC CYLINDER, RIGID COUPLER AND NO HARD STOP:
 #SBS40-100-H-C1
 TO ORDER UNIT AS SHOWN WITH HYDRAULIC CYLINDER, RAP COUPLER AND NO HARD STOP:
 #SBS40-98-H-RAP-C1
 TO ORDER UNITS AS SHOWN, RIGID COUPLING, HARD STOP OPTION, & WITH A 4.75mm SHIM
 #SBS40-100-RIGID-HS-C1-4C

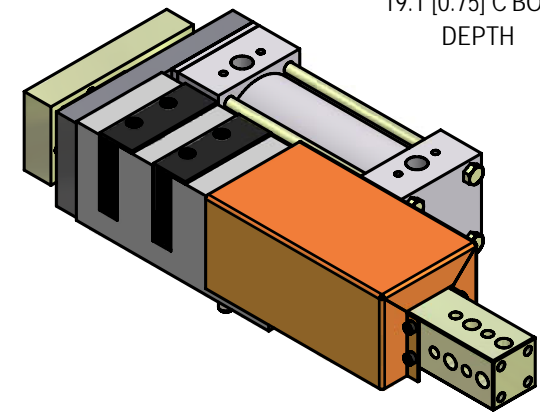
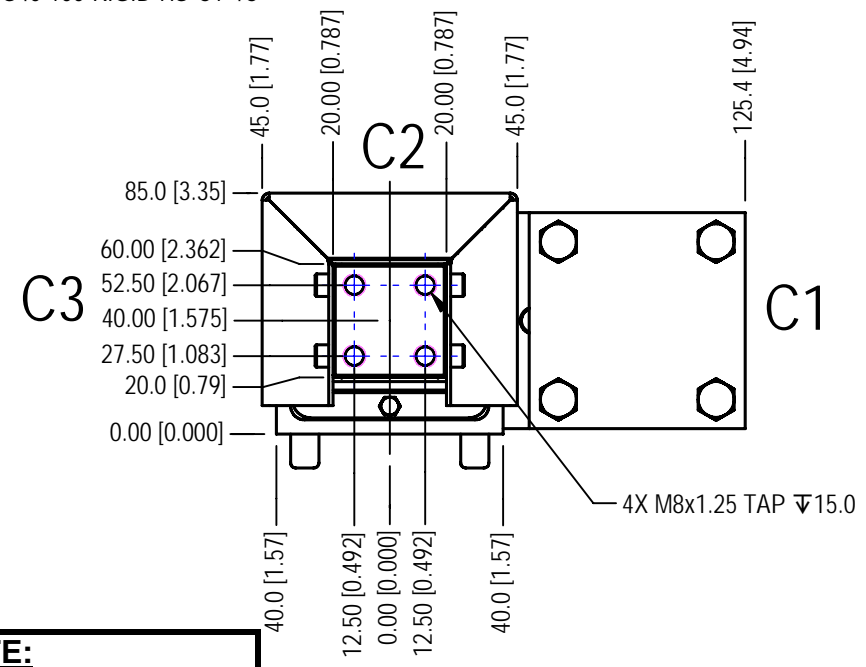
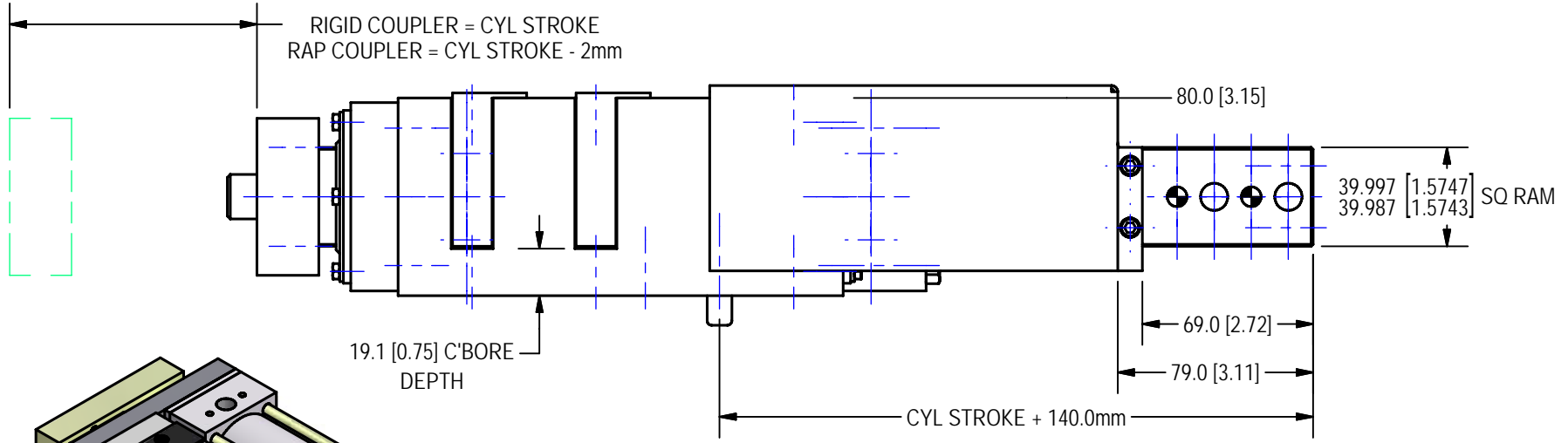

SHIM NOTE:

WHOLE MM CODES		QUARTER MM CODES	
THK (mm)	CODE	.25 THK (mm)	CODE
1	1	0.00	0
2	2	0.25	A
3	3	0.50	B
4	4	0.75	C
5	5		

UNIT WEIGHT 28 LBS.

WELKER BEARING COMPANY

TOOL NAME: SBS-40 SERIES SHOTPIN - 75-100 STROKE

TEMPLATE

DATE	STATUS	DRAWN BY	DATE	CHK'D BY	ENG APPROVAL
12/14/2004	Quick Change	DJH	10/19/2005		
SCALE	None	FILE NAME	SBS40L03-4		

UNITS ARE MILLIMETERS (i.e. XXmm [x.xxx"])
 DO NOT SCALE DRAWING