

OTHER CUSHIONS AVAILABLE FOR DIFFERENT WEIGHTS AND SPEEDS

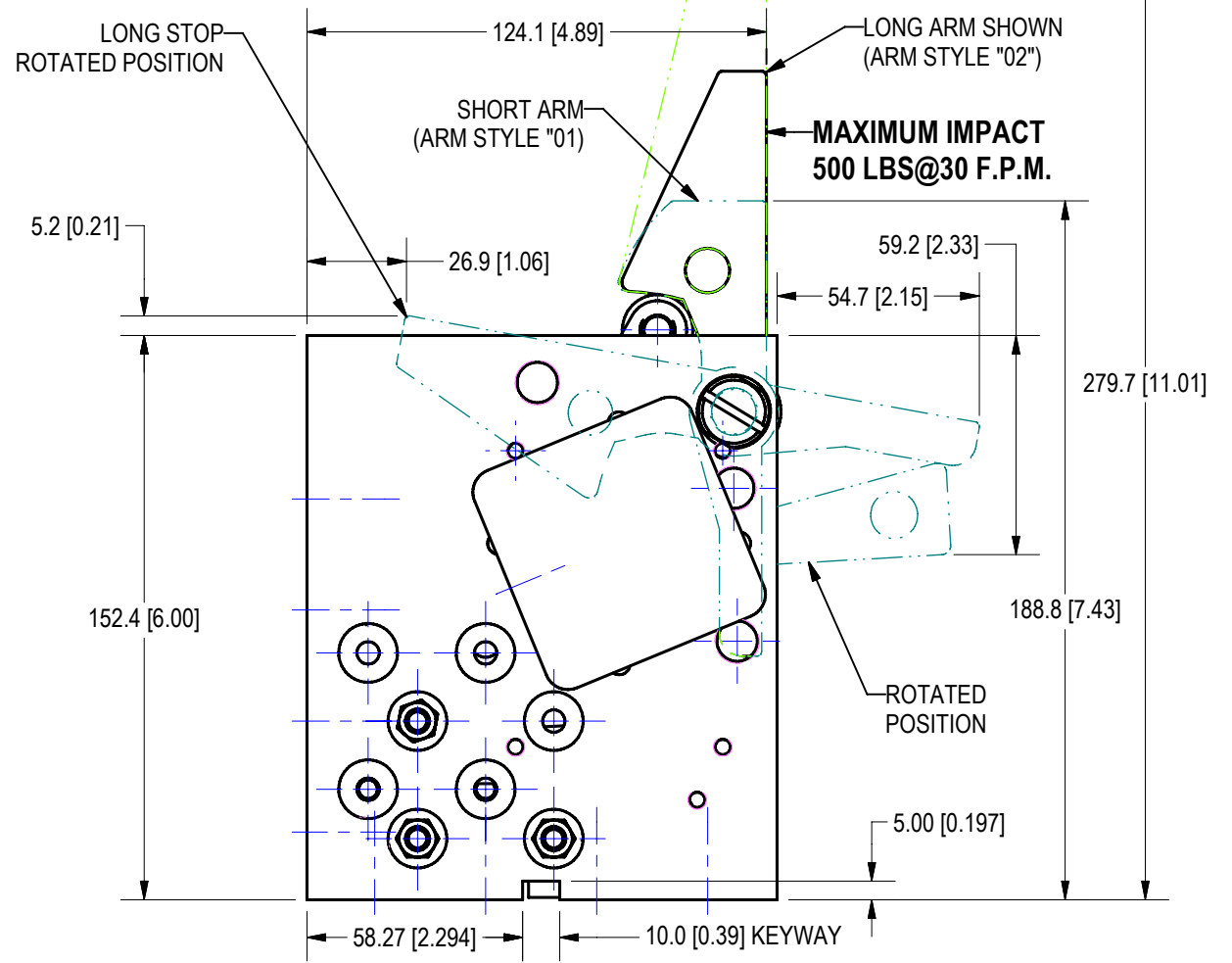

ORDER INFORMATION **CMX** **01** **L** **04** **A** **00**

Actuator

- 01** Rotary air vane, 90° Rotation
- 02** 40mm Bore, 75m Stroke
- 03** 63mm Bore, 75m Stroke
- 04** 100mm Bore, 75m Stroke
- 05** DC Electric Stepper
- 06** AC Motor

Actuator Position

- L** Left Hand Side (Actuators 01,05,06)
- R** Right Hand Side (Actuators 01,05,06)
- H** Horizontal (Actuators 02,03,04)
- V** Vertical (Actuators 02,03,04)

Arm Style

- 01** Short Arm
- 02** Long Arm
- 03** Extra Long Arm
- 04** Long Arm with Tapped Holes

ACTUATOR "01" TEMPLATE

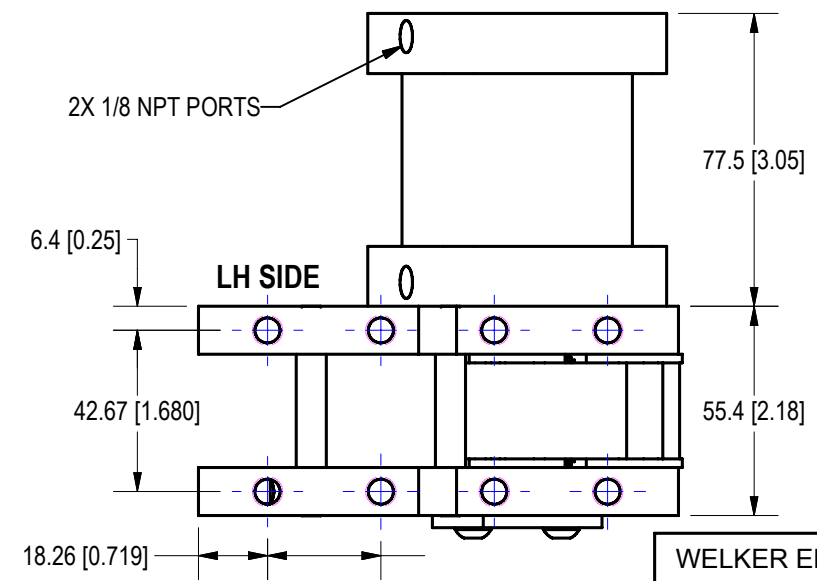

UNITS ARE MILLIMETERS (i.e.X.XXmm [x.xxx"])
DO NOT SCALE DRAWING

PATENT #6,119,843
OTHER PATENTS PENDING

DATE	12/7/2007	STATUS	Quick Change
DRAWN BY	JMP	SCALE	1:4
DATE	10/19/2005	CHK'D BY	TNT
FILE NAME	CMXL01	ENG APPROVAL	

WELKER ENGINEERED PRODUCTS

TOOL NAME
PALLET STOP
TEMPLATE

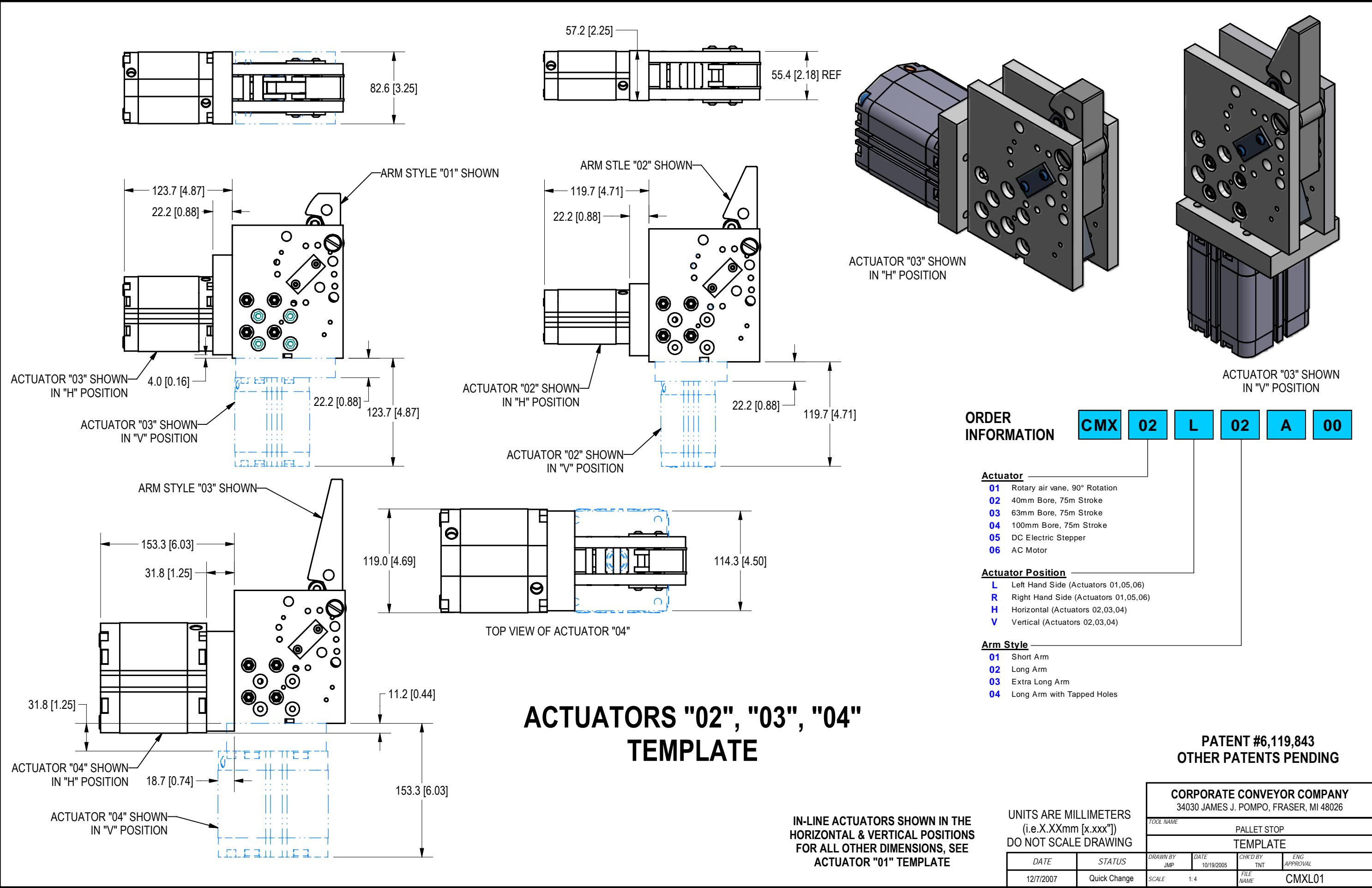

**PATENT #6,119,843
OTHER PATENTS PENDING**

CORPORATE CONVEYOR COMPANY 34030 JAMES J. POMPO, FRASER, MI 48026					
TOOL NAME: PALLET STOP					
TEMPLATE					
DATE	STATUS	DRAWN BY	DATE	CHKD BY	ENG APPROVAL
12/7/2007	Quick Change	JMP	10/19/2005	TNT	
SCALE: 1:4		FILE NAME: CMXL01			

UNITS ARE MILLIMETERS
(i.e.X.XXmm [x.xxx"])
DO NOT SCALE DRAWING

MOTOR SHOWN IN "R" POSITION ON RH SIDE

MOTOR SHOWN IN "L" POSITION ON LH SIDE

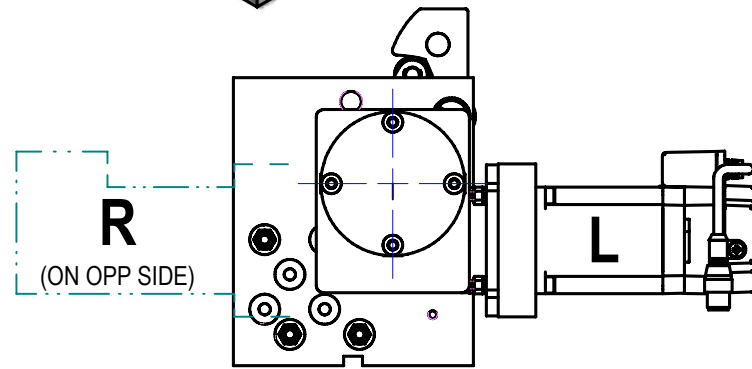
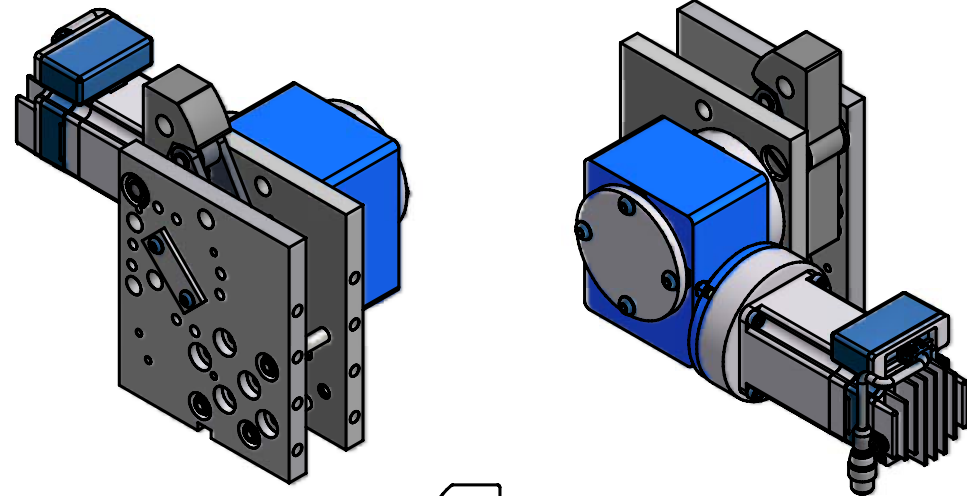

SCALE 1 / 4

**LH SIDE MOTOR POSITIONS
RH SIDE IS OPPOSITE**

MALE 4-PIN
M12 MICRO
CONNECTOR



Pin	I/O Block Function	I/O Block Description	Signal (2 AMP Draw)
1	V+	Unswitched Input Power	+24Vdc To Pallet Stop
2	Input B	Unclamped (Pin Extended)	+24Vdc To Pallet Stop
3	V-	Input Power Common	0Vdc To Pallet Stop
4	Input A	Clamped (Pin Retracted)	+24Vdc To Pallet Stop

OUTPUTS 2 AND 4 MUST BE MAINTAINED DURING DRIVE MOTION. LOSS OF THE OUTPUT WILL CAUSE DRIVE MOTION TO STOP. DURING PALLET STOP OPERATION, THE DRIVE OPERATES AT SPEED UNTIL OUTPUT IS LOST.

POWER ARM TRAVEL IS CONTROLLED BY EXTERNAL CONTROLS. THE MOTION OUTPUT SHOULD BE MAINTAINED UNTIL IN POSITION, AS SENSED BY A PROX SWITCH. THE MOTION OUTPUT SHOULD THEN BE DROPPED, AND THE DRIVE WILL STOP.

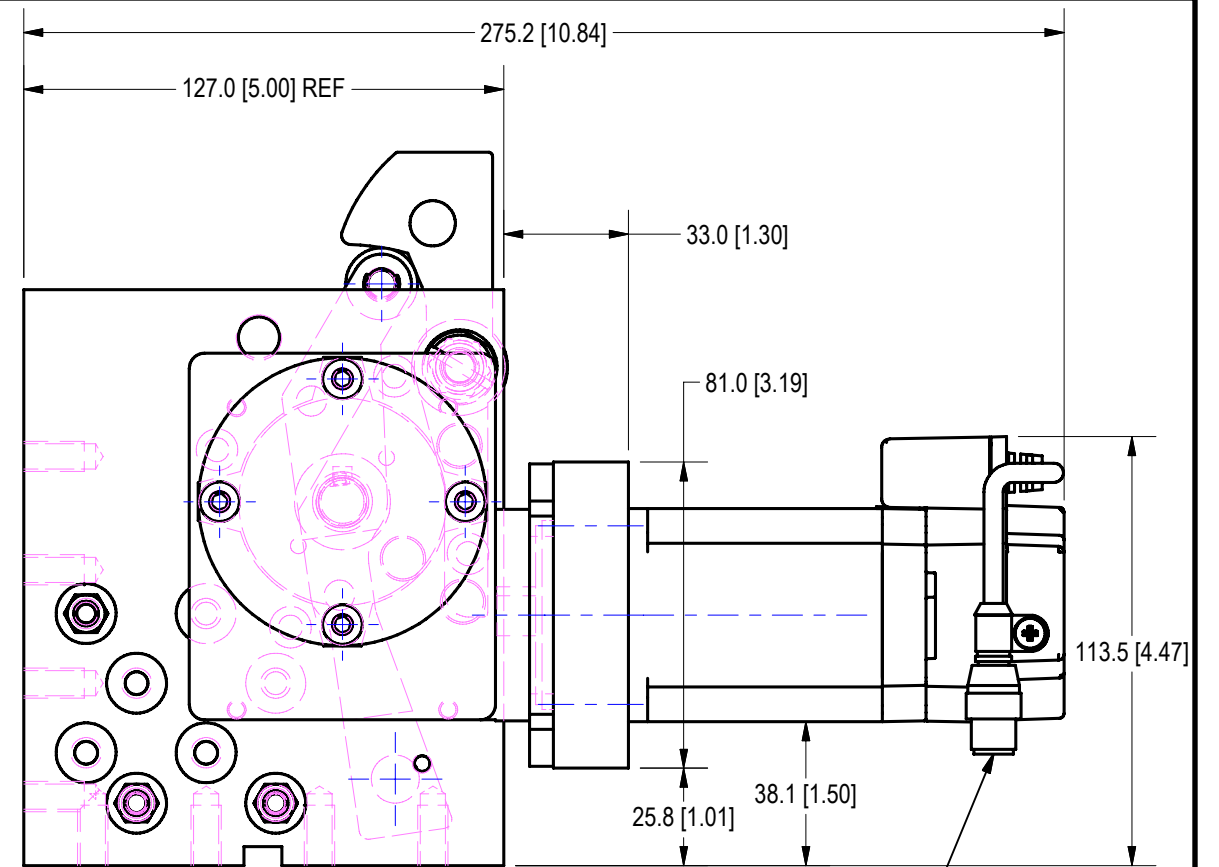
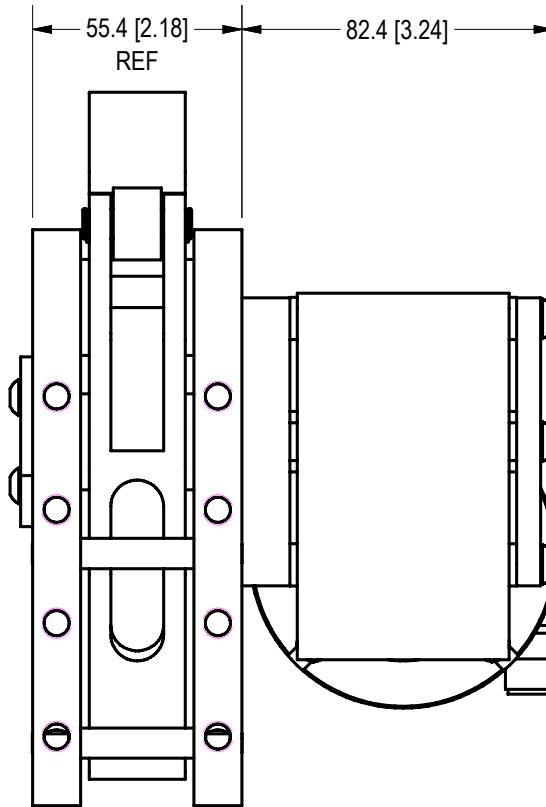

M12 MICRO CONNECTOR
FIELD ROTATABLE

CMX 05 L 01 A 00

Actuator

- 01 Rotary air vane, 90° Rotation
- 02 40mm Bore, 75m Stroke
- 03 63mm Bore, 75m Stroke
- 04 100mm Bore, 75m Stroke
- 05 DC Electric Stepper
- 06 AC Motor

Actuator Position

- L Left Hand Side (Actuators 01,05,06)
- R Right Hand Side (Actuators 01,05,06)
- H Horizontal (Actuators 02,03,04)
- V Vertical (Actuators 02,03,04)

Arm Style

- 01 Short Arm
- 02 Long Arm
- 03 Extra Long Arm
- 04 Long Arm with Tapped Holes

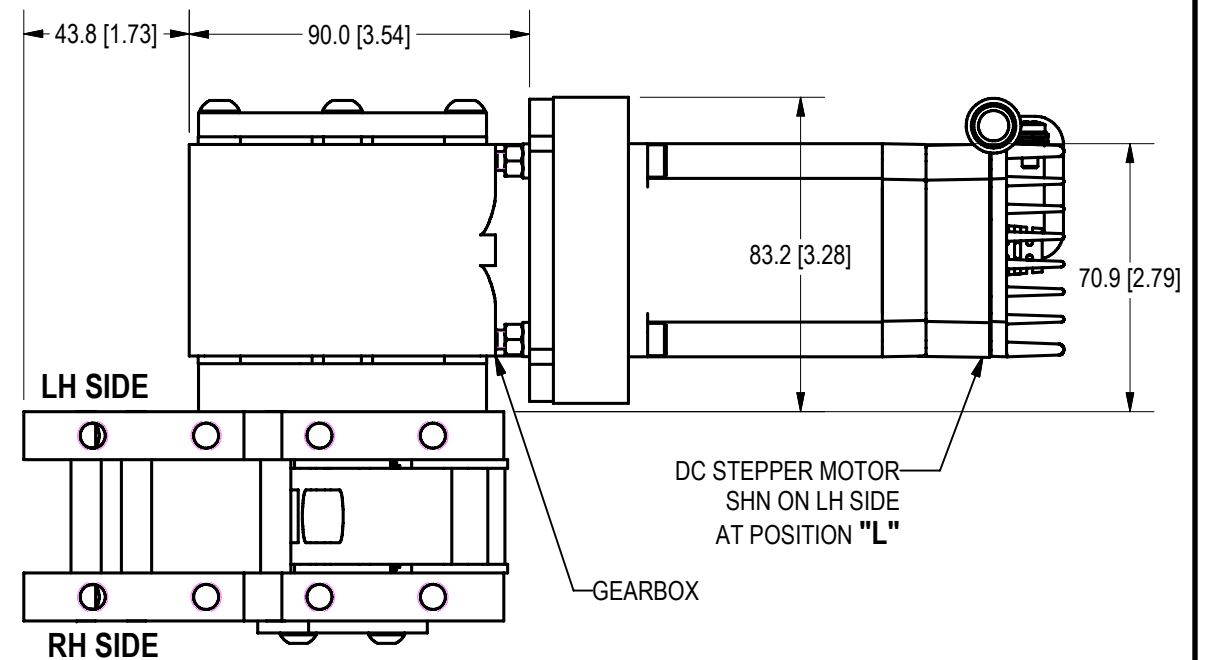

DC STEPPER MOTOR
SHN ON LH SIDE
AT POSITION "L"

GEARBOX

ACTUATOR "05" TEMPLATE

FOR ALL OTHER DIMENSIONS, SEE ACTUATOR "01" TEMPLATE

PATENT #6,1198,43
OTHER PATENTS PENDING

UNITS ARE MILLIMETERS
(i.e.X.XXmm [x.xxx"])
DO NOT SCALE DRAWING

CORPORATE CONVEYOR COMPANY 34030 JAMES J. POMPO, FRASER, MI 48026					
TOOL NAME PALLET STOP					
TEMPLATE					
DRAWN BY JMP	DATE 10/19/2005	CHK'D BY TNT	ENG APPROVAL		
DATE 12/7/2007	STATUS Quick Change	SCALE 1:4	FILE NAME CMXL01		

MOTOR - RH SIDE (OPPOSITE)
OPTION "R" POSITION

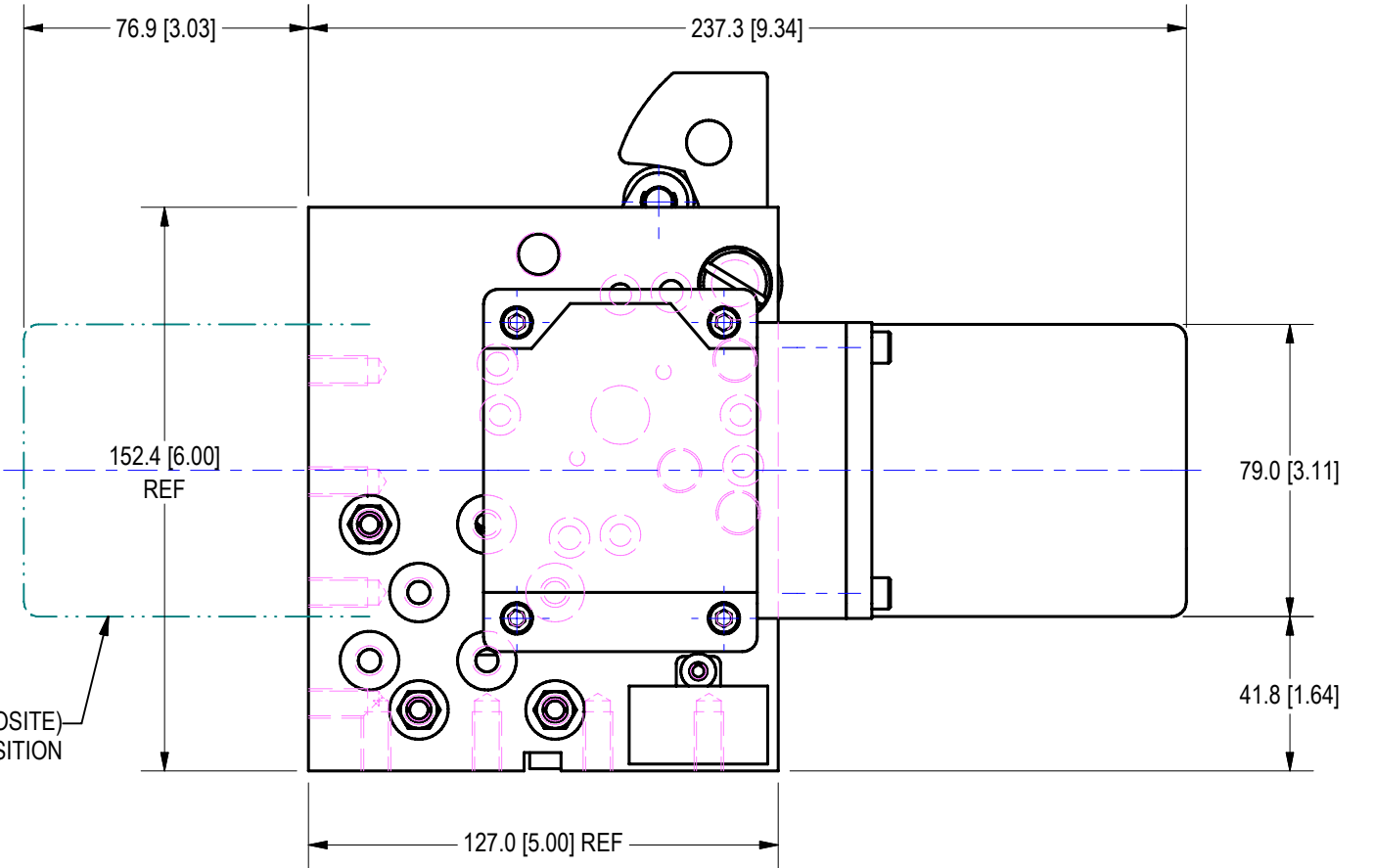
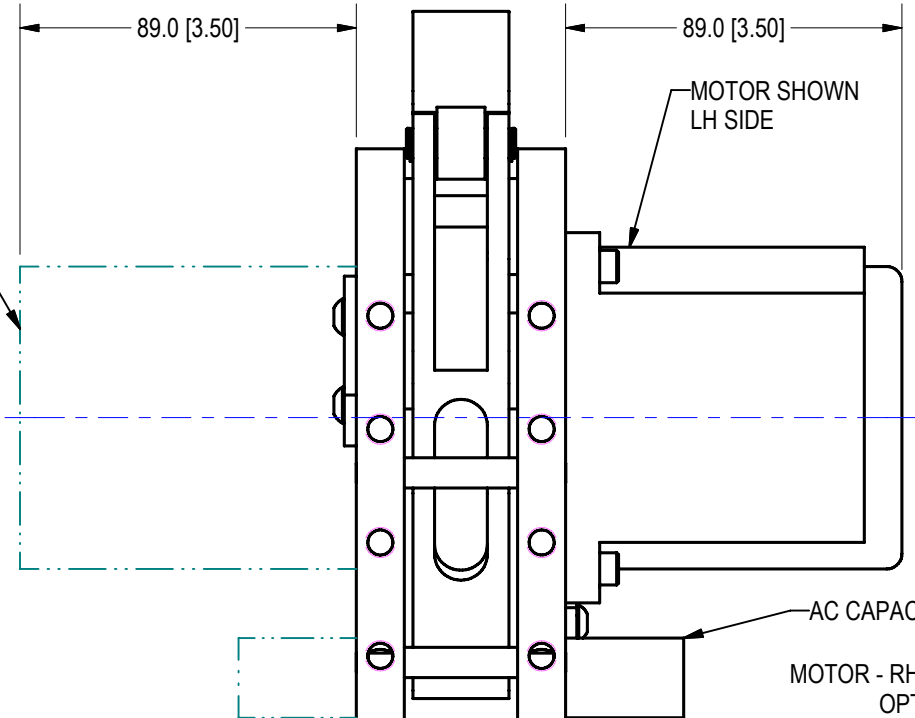

CMX 06 L 01 A 00

- Actuator**
- 01 Rotary air vane, 90° Rotation
 - 02 40mm Bore, 75m Stroke
 - 03 63mm Bore, 75m Stroke
 - 04 100mm Bore, 75m Stroke
 - 05 DC Electric Stepper
 - 06 AC Motor
- Actuator Position**
- L Left Hand Side (Actuators 01,05,06)
 - R Right Hand Side (Actuators 01,05,06)
 - H Horizontal (Actuators 02,03,04)
 - V Vertical (Actuators 02,03,04)
- Arm Style**
- 01 Short Arm
 - 02 Long Arm
 - 03 Extra Long Arm
 - 04 Long Arm with Tapped Holes

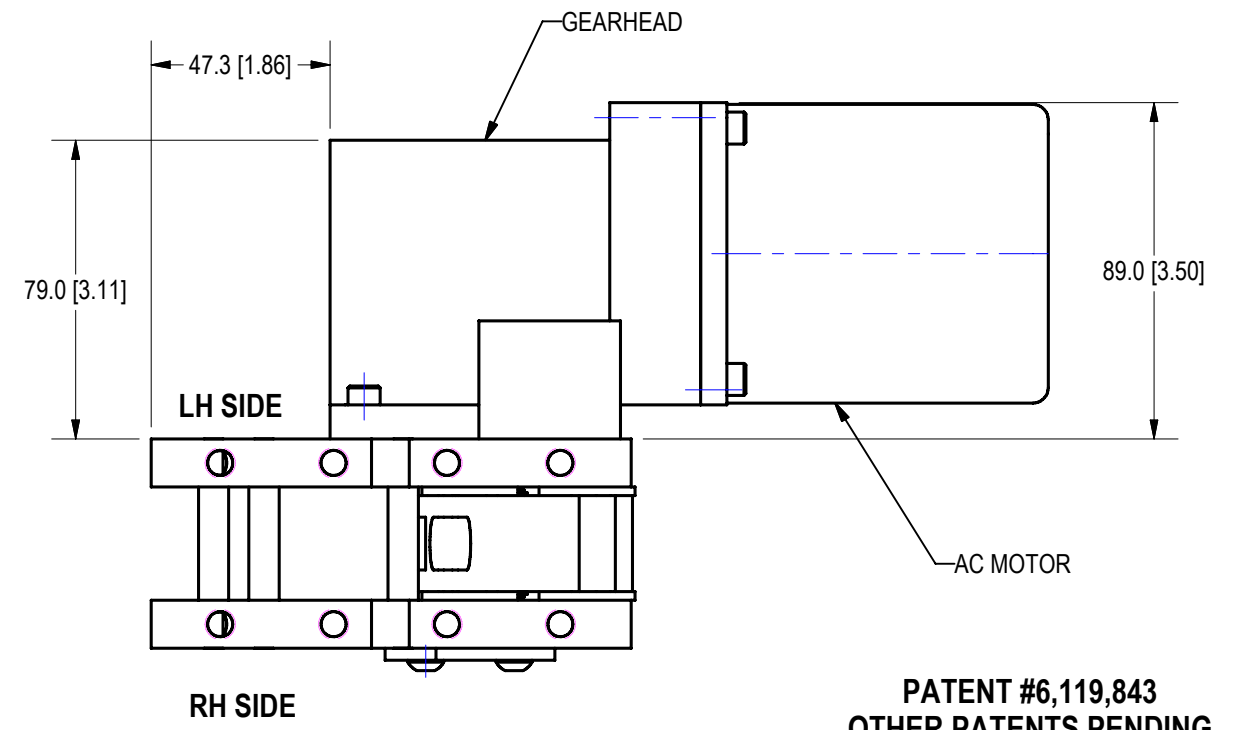

Connection Diagram

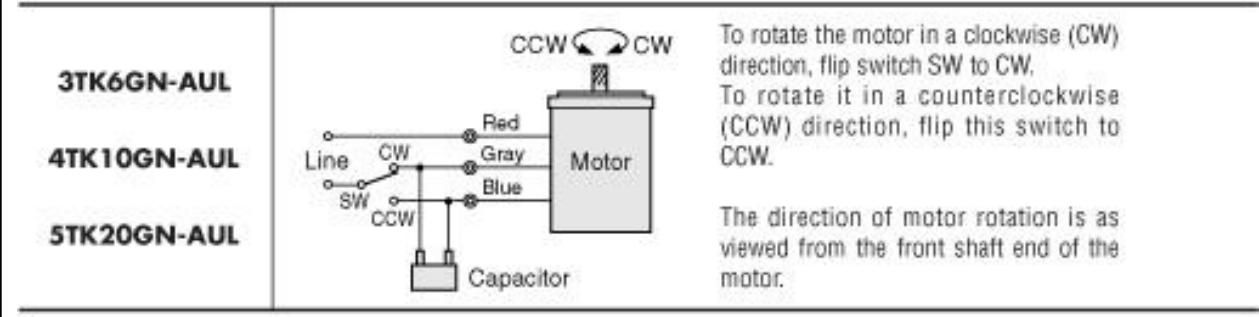

- The direction of motor rotation is as viewed from the shaft end of the motor.
- CW represents the clockwise direction, while CCW represents the counterclockwise direction.
- Connection diagrams are also valid for the equivalent round shaft motors.

ACTUATOR "06" TEMPLATE
FOR ALL OTHER DIMENSIONS, SEE ACTUATOR "01" TEMPLATE

UNITS ARE MILLIMETERS
(i.e.X.XXmm [x.xxx"])
DO NOT SCALE DRAWING

PATENT #6,119,843
OTHER PATENTS PENDING

CORPORATE CONVEYOR COMPANY
34030 JAMES J. POMPO, FRASER, MI 48026

TOOL NAME		PALLET STOP			
DATE		TEMPLATE			
DRAWN BY	DATE	CHK'D BY	ENG	APPROVAL	
JMP	10/19/2005	TNT			
SCALE	1:4	FILE NAME	CMXL01		